

Sponges & Scouring Pads

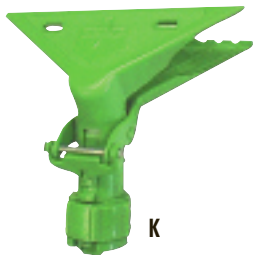

The time to get abrasive is now!

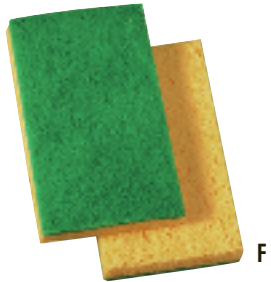
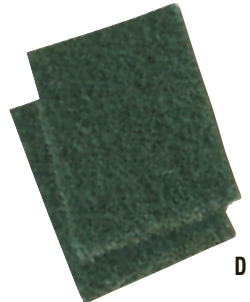
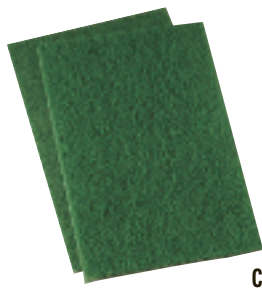
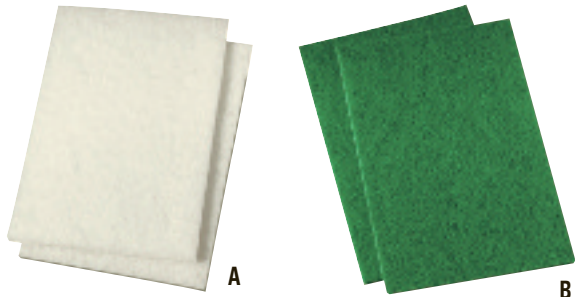

A. Light-Duty Scour Pad

For light-duty cleaning. Won't scratch or dull most surfaces. Ideal for glass, stainless steel, porcelain, chrome, copper and ceramic surfaces. White, 6 x 9. 20 pads per case.

PAD 198	Case
---------	------

B. Medium-Duty Scour Pad

Medium-duty for most common cleaning jobs. Cleans pots, pans, kitchen equipment, floors, stairways and baseboards. Green, 6 x 9. 20 pads per case.

PAD 196	Case
---------	------

C. Heavy-Duty Scour Pad

Thick, heavy-duty for tough cleaning jobs. Ideal for cleaning food processing equipment and heavily baked-on foods. Removes scuff marks from floors. Green, 6 x 9. 15 pads per case.

PAD 186	Case
---------	------

D. Extra Heavy-Duty Scour Pad

For extra heavy-duty cleaning of heavily encrusted pots and pans, kitchen equipment and grimy maintenance equipment. Alternative to stainless steel scrubbers. Blue/Gray, 3.5 x 5. 20 pads per case.

PAD 188	Case
---------	------

E. Light-Duty Scrubbing Sponge

Absorbent cellulose sponge on one side, scour pad on the other. Won't scratch most surfaces. Cleans stainless steel, glass, ceramic, fine china, porcelain and nonstick cooking surfaces. Yellow/White, 3.6 x 6.1 x 0.7. 20 sponges per case.

PAD 163-20	Case
------------	------

F. Medium-Duty Scrubbing Sponge

Absorbent cellulose sponge on one side, nylon scouring pad on the other. The ultimate combination for cleaning ceramic fixtures, kitchen and bath surfaces. Yellow/Green, 3.6 x 6.1 x 0.7. 20 sponges per case.

PAD 174	Case
---------	------

G. Small Pink Cellulose Sponge

Stays fresh longer. Resists sponge odors, staining and crumbling caused by bacteria. Lasts through hundreds of uses. 3.6 x 6.5 x 0.9. 2 sponges per pack; 24 packs per case.

PAD CS1A	Case
----------	------

Beige Cellulose Sponges

More absorbent than polyurethane sponges. Stronger, less likely to fall apart. 1 sponge per pack; 24 packs per case.

No.	Size	Case
H. PAD CS2	Medium, 3.66 x 6.08 x 1.55	
I. PAD CS3	Large, 4.27 x 7.8 x 1.55	



Quality Tools for Smart Cleaning

J. Fixi Clamp Sponge

Attacks hard-to-reach dirt when attached to the Fixi Clamp UNG FIXI (sold separately). 8 x 2 x 3.

UNG SP01	Each
----------	------

K. Fixi Clamp

Grips sponge UNG SP01 (sold separately), rags, mop heads and cloths. Combined with an Unger® telescopic pole (sold separately), the clamp becomes a high-rise cleaning tool.

UNG FIXI	Each
----------	------